



# NEIGHBORHOOD WATCH BULLETIN

Fountain Valley Police Department  
10200 Slater Avenue, Fountain Valley CA 92708  
Paul A. Sorrell ~ Chief of Police



## Police Phone Numbers

Non-Emergency: 593-4485 / 593-4486  
Watch Commander: 593-4487  
Crime Prevention Office: Sherri Lerner 593-4526  
Crime in Progress: 9-1-1  
Police Web Site: [www.fvcpd.org](http://www.fvcpd.org)



## Neighborhood Watch

Neighborhood Watch Office: 593-4488  
Coordinator Volunteer: James Black  
Asst. Volunteer Coordinator: Barbara Larson  
City Web Site: [www.fountainvalley.org](http://www.fountainvalley.org)  
Report Graffiti: 593-4486 / City Hall: 593-4400

MARCH / APRIL 2009 ~ Circulation 18,500

## CALIFORNIA CRACKS DOWN ON CYBERBULLIES

It's a problem that is growing. Over 40 percent of all teenagers with Internet access have been bullied on-line in the past year, and only ten percent told a parent. And girls are much more likely to be the victims than boys, according to the National Crime Prevention Council. A new law will allow schools to suspend or, in some cases, even expel those found guilty of cyberbullying.

## DID YOU LOSE SOMETHING?

A duffle bag of motorcycle gear was found in December 2008 near Santa Rita Street in our city. If you think it might be yours, please contact our property department at the Fountain Valley Police Department at 714-593-4485 and refer to case number 08-6103.

## STAY ALERT

Terrorist Attacks are preceded by indicators & warnings. Even though we are fortunate in that Fountain Valley is so safe, it is important that all citizens work together to confront the threat of terrorism. Indicators and warnings are unusual activities such as someone seen taking pictures and surveying a particular area, discreet use of cameras, camera phone, video recorder or note taking at non-tourist locations (e.g., government facilities, airports, bridges, chemical/water/electrical plants), or shows interest in areas not typically of interest to visitors or tourists. Terrorist attacks typically involve meticulous planning by perpetrators who must conduct their activity in secret. Although terrorists go to great lengths to remain undetected, many terrorist attacks are preceded by specific indicators and warnings that, if detected, can lead to the disruption of the attack. Wherever we work or live, we share responsibility to recognize and report suspicious activity that may be associated with terrorism. Make no mistake about it—there are individuals residing inside the United States, intent on carrying out terrorist attacks.

STAY ALERT. Go to the website, [www.terrorismtip.info](http://www.terrorismtip.info) or call 1-877-A-THREAT a toll free number for the general public who wish to submit a terrorism leads and notify your local police department.

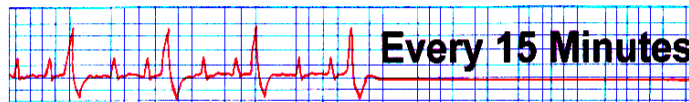

On Thursday and Friday, March 26 & 27, 2009, the Fountain Valley Police Department and Los Amigos High School will present the "Every 15 Minutes" program to the junior and senior classes. This two-day program focuses on personal safety, drinking and driving and the potential consequences of poor decision-making. The program goal is to reduce alcohol related traffic collisions in our community. The "Every 15 Minutes" program is presented prior to spring break, prom and graduation ceremonies, which makes it a timely event.

## YOU DRINK...YOU DRIVE...YOU LOSE!

For additional information, please contact Sherri Lerner in the Crime Prevention Unit at the Fountain Valley Police Department at (714) 593-4526.

## ALERT, AWARE, INVOLVED

Effective crime prevention programs encourage older citizens to become:

- **ALERT:** to their surroundings and common-sense measures that reduce the risk of victimization;
- **AWARE:** of how to proceed if they are victims of crime and what community agencies can help them;
- **INVOLVED:** in activities that enrich their lives and improve the quality of life in the neighborhoods in which they live;

Older Americans are seen as valuable community resources who—as tutors, neighborhood watch organizers, mentors, and citizen patrols, to name only a few roles—make enormous contributions to the community's well-being.

**DAYLIGHT SAVINGS TIME MARCH 8<sup>TH</sup>  
MOVE YOUR CLOCKS FORWARD**

**FIRST DAY OF SPRING~ MARCH 20<sup>TH</sup>**



**HAPPY ST. PATRICK'S DAY**

**~PRINTING PROVIDED BY OFFICE DEPOT~**

# CRIME WATCH

## FOUNTAIN VALLEY REPORTING DISTRICTS

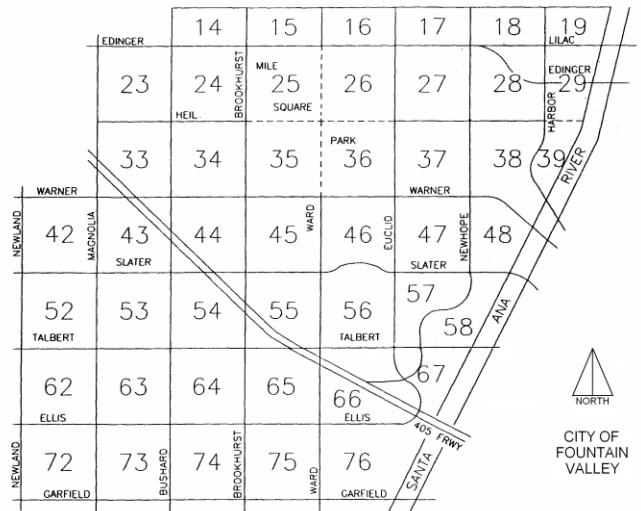

DECEMBER 2008 RESIDENTIAL BURGLARIES ( 4 )				
RD	STREET	DATE	TIME	ENTRY
46	REIMER	12-03	8:30 AM	F
27	CORAL ALOE	12-08	2:45 PM	F
56	LA ROSA	12-12	10:30 PM	NF
47	SLATER	12-20	1:25 PM	NF
DECEMBER 2008 THEFT FROM VEHICLES = 33				
RD WITH THE HIGHEST OCCURANCE: RD 28=5				
DECEMBER 2008 TOTAL STOLEN VEHICLES 8				
RD WITH HIGHEST OCCURANCE: RD 23/47=2 EACH				

JANUARY 2009 RESIDENTIAL BURGLARIES (11)				
RD	STREET	DATE	TIME	ENTRY
24	TALBERT	1-07	7:00 PM	F
23	ROUTT	1-13	7:20 AM	NF
37	MT. EDEN	1-13	8:00 PM	UNKN
65	POWDERHORN RIVER	1-16	6:00 PM	NF
44	BROOKHURST	1-17	5:00 PM	F
28	HARBOR	1-19	8:15 AM	UNKN
56	ANGEL	1-28	6:30 AM	UNKN
65	LOS CANARIOS	1-28	7:00 AM	NF
75	LAS FLORES	1-28	8:15 AM	F
46	LA BATISTA	1-30	8:30 AM	F
34	MADRONE	1-30	12:30 PM	F
JANUARY 2009 THEFT FROM VEHICLES = 34				
RD WITH THE HIGHEST OCCURANCE: RD16,28,33,45 & 56=3 EACH				
JANUARY 2009 TOTAL STOLEN VEHICLES 7				
RD WITH HIGHEST OCCURANCE: RD 58=2 EACH				

**COMMUNITY POLICING**  
 If you have a concern regarding crime trends or are seeking assistance in solving neighborhood issues, please contact the Watch Commander at 714-593-4487

**PLEASE VISIT YOUR POLICE DEPARTMENT WEBSITE AT [WWW.FVPD.ORG](http://WWW.FVPD.ORG)**



**FOUNTAIN VALLEY NEIGHBORHOOD WATCH IS LOOKING FOR YOU!! WE ARE IN NEED OF AN AREA COORDINATOR FOR THE SOUTHEAST SECTION OF OUR CITY. IF YOU WOULD LIKE TO VOLUNTEER FOR THIS POSITION, PLEASE CONTACT THE CRIME PREVENTION OFFICE AT (714) 593-4526.**

**News from the National Crime Prevention Council**  
**Trash or treasure? Caution: Criminals may cruise your garbage for signs of valuables.** Your trash could tell a tale of treasure for would-be-thieves. When discarding the boxes from that Wii® or the 50-inch LCD television, the NCPC says you may be bragging to a thief about what lies behind your front door. NCPC says criminals drive through neighborhoods looking for evidence of new TV's, computers, and other expensive items and then target your house for a break-in.

**DO YOU KNOW THIS NICE PLACE?**

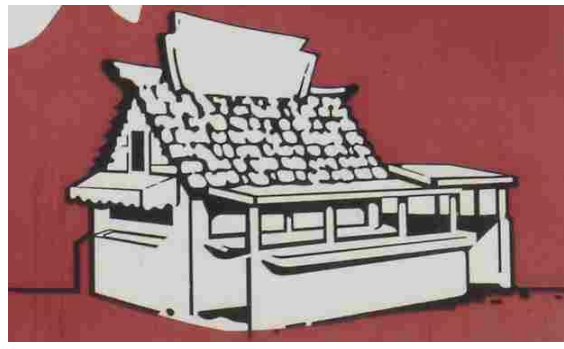

**LOOK FOR THE ANSWER IN THE MAY/JUNE 2009 BULLETIN**

**LAST ISSUE: THE TUTORING CLUB**

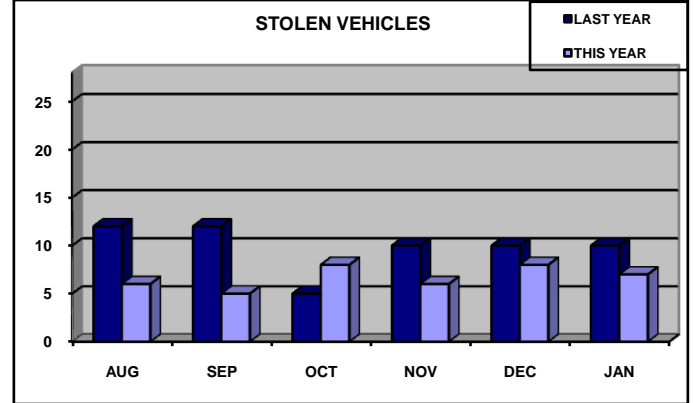
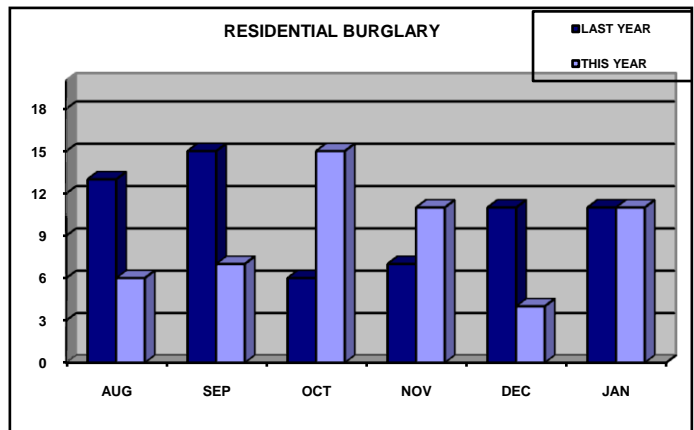

**KNOW WHAT THE BEST CRIME DETERENT IS? A GOOD NEIGHBOR**  
**JOIN THE TEAM!**